

atan

(+351) 93 643 76 49 | comercial@atan.pt | www.atan.pt



SPLITS NUTS



TNS-112
MADE IN U.S.A.
RANGE
 $1\frac{5}{8}$ "-1 $\frac{3}{4}$ "
41mm

WWW.TORCUP.COM



TNS NUT SPLITTER

TNS

THE WORLD'S MOST SOUGHT AFTER NUT SPLITTER

The TorcUP TNS Series Nut Splitter is there when you just cannot turn the nut. Eliminating the need for torches and other less predictable options, the TNS Series Nut Splitter is durable, reliable and safe. Its simple design and wide range make it the most in demand nut splitter available. The TNS Series Nut Splitter is made in the USA and provides an uncomplicated solution to what can be a difficult issue.



THE RIGID DESIGN

EASY SETS UP AND CUTS WITHIN MINUTES

SAFE NO SPARKS, NO FLAMES, NO FLYING FRAGMENTS

FAST CUTS NUTS IN SECONDS COMPARED TO HOURS WITH TORCH

FLEXIBLE TOOL HEAD FITS ALL API AND ANSI FLANGES

VERSATILE CUTS NUTS WITHOUT ANY DAMAGE TO STUD

AND WHEN IT IS IMPORTANT ...

WARRANTY CARRIES 13 MONTH FACTORY WARRANTY FROM DEFECTS IN MATERIAL AND/OR WORKMANSHIP (EXCLUDES WEAR PARTS SUCH AS CHISELS)

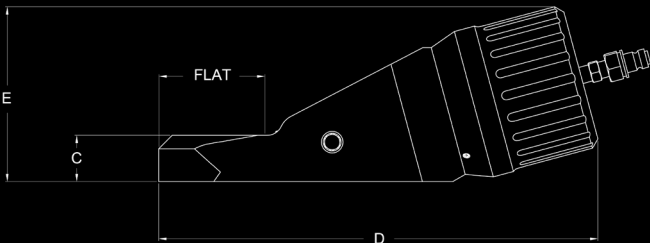
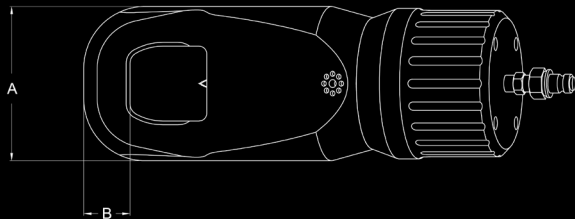

MADE IN USA

TNS SERIES

Part Number	A	B	C	D	E	Flat	Chisel	RANGE
TNS-012	2.00" / 50.8mm	0.40" / 10.2mm	0.63" / 15.9mm	6.71" / 170.4mm	2.76" / 70.1mm	1.11" / 28.2mm	TNS-10T-CHISEL	1/2" - 3/4" 12 - 19mm
TNS-100	2.25" / 57.2mm	0.40" / 10.2mm	0.72" / 18.3mm	6.94" / 176.3mm	2.77" / 70.4mm	1.30" / 33.0mm	TNS-10T-CHISEL	13/16" - 1" 20 - 25mm
TNS-104	3.75" / 95.3mm	1.00" / 25.4mm	1.13" / 28.6mm	11.79" / 299.5mm	5.07" / 128.8mm	2.63" / 66.7mm	TNS-30T-CHISEL	1 1/16" - 1 1/4" 27 - 32mm
TNS-108	3.75" / 95.3mm	1.13" / 28.7mm	1.13" / 28.7mm	12.19" / 309.6mm	5.08" / 129.0mm	2.53" / 64.3mm	TNS-30T-CHISEL	1 5/16" - 1 1/2" 33 - 38mm
TNS-112	4.50" / 114.3mm	1.38" / 34.9mm	1.25" / 31.8mm	13.95" / 354.3mm	5.71" / 145.0mm	3.23" / 82.0mm	TNS-50T-CHISEL	1 9/16" - 1 3/4" 39 - 45mm
TNS-200	5.00" / 127.0mm	1.50" / 38.1mm	1.50" / 38.1mm	14.23" / 361.4mm	5.68" / 144.3mm	3.52" / 89.4mm	TNS-50T-CHISEL	1 13/16" - 2" 46 - 50mm
TNS-208	6.25" / 158.8mm	1.50" / 38.1mm	2.00" / 50.8mm	18.19" / 462.0mm	7.75" / 196.9mm	3.63" / 92.2mm	TNS-75T-CHISEL	2 1/16" - 2 1/2" 50 - 63mm
TNS-300	3.50" / 165.1mm	1.53" / 38.8mm	2.50" / 63.5mm	18.57" / 471.7mm	7.70" / 195.6mm	4.50" / 114.3mm	TNS-75T-CHISEL	2 9/16" - 3" 63 - 76mm



HPI100

HYDRAULIC HAND PUMP

FEATURES

- ♦ Single Acting / Single Hydraulic Port
- ♦ Two speed operation which reduces user fatigue
- ♦ Internal pressure relief valve for overload protection
- ♦ Large oil capacity to power a wide range of tools
- ♦ Constructed of high strength lightweight aluminum alloy
- ♦ Functions in horizontal and vertical positions
- ♦ Maximum working pressure: 10,000 psi / 700 bar

API100

HYDRAULIC AIR PUMP

FEATURES

- ♦ Single Acting / Single Hydraulic Port
- ♦ Pressure relief valve for overload protection
- ♦ Required air pressure range: 110-175psi. / 7.5-12 bar
- ♦ Dust cover protection for the release control valve
- ♦ High strength reinforced alloy reservoir
- ♦ Maximum working pressure: 10,000 psi / 700 bar



EP100

ELECTRIC PUMP

FEATURES

- ♦ Single Acting / Single Hydraulic Port
- ♦ Quiet operation meets OSHA regulations (80dBA)
- ♦ 2 speed operation allows for faster cylinder advance
- ♦ Internal filter keeps contamination from damaging pump
- ♦ 10 ft. remote pendant switch to control motor on/off
- ♦ Maximum working pressure: 10,000 psi / 700 bar



torcup

Worldwide Headquarters

1025 Conroy Place

Easton, PA 18040 USA

TOLL FREE: 1-888-TorcUP-1

TELEPHONE: +1-610-250-5800

FAX: +1-610-250-2700

www.torcup.com



Catalog 2016 04

TorcUP products are subject to continual development and TorcUP reserves the right to make changes to the specifications and design of their products without prior notice. All rights are reserved. Reproduction in whole or in part without permission of TorcUP Inc. is prohibited.